

SITE PLAN



TENTERFIELD
KENDAL



KEY

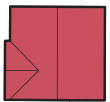

The Webster
4 bedroom semi-detached house

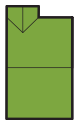

The Mercer
3 bedroom semi-detached house

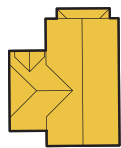

The Lister
4 bedroom detached house



The Bowker
4 bedroom semi-detached townhouse

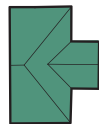

The Sherman
2 bedroom end terrace house

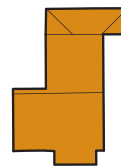

The Walker
2 bedroom terraced house

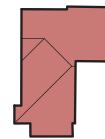

The Dyer
2 bedroom terraced house

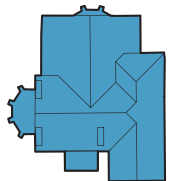

1 & 2 Bed Apartments
2 of which will be sold as Affordable Homes

Site plan shown for guidance purposes only. Not to scale. Certain details may vary and the development may be subject to alteration, site and planning requirements or may alter our plans. This does not constitute a part of any contract or offer.

SPECIFICATION



TENTERFIELD
KENDAL

PLOTS 1 - 8

- Item included as standard to all plots unless listed
- Optional item available at extra cost (subject to stage of construction of the property)

- Hacker kitchens by Webbs of Kendal with soft close drawers & doors
- Choice of Hacker worktop and upstand to kitchen
- AEG 'A' rated multifunction stainless steel electric oven
- AEG built-in microwave
- AEG touch control ceramic electric hob
- Stainless steel cooker hood
- Composite granite-style one and a half bowl sink and mixer tap
- Hansgrohe swivel spout sink mixer tap
- Zanussi A+ rated integrated tall fridge freezer (70/30)
- Zanussi A+ rated integrated dishwasher
- Zanussi A++ rated integrated washing machine
- LED integral wall under unit lights
- Duravit bathroom pottery
- Tos vanity basin with storage to en-suite
- Hansgrohe chrome taps & thermostatic shower pipe with shower head & hand shower to en-suite
- Hansgrohe thermostatic bath mixer with hair wash shower head to bath or with shower rail to bathroom where no en-suite
- Chrome heated towel rail to family bathroom & en-suite
- Chrome heated towel rail to cloakroom
- Cloakroom/bathroom/en-suite half tiled to all walls
- Amtico flooring to bathroom and en-suite
- LED inset spotlights to kitchen, bathroom & en-suite (as plan)
- Contemporary skirting and architraves
- Oak veneer internal doors with contemporary chrome door handles
- 'A' rated energy saving double glazed PVCu windows
- Energy efficient timber frame construction
- Natural slate roofs
- Thermostatic radiator valves
- Pressurised hot water storage cylinder
- 'A' rated condensing central heating boiler with 5 year warranty
- Seven day heating control unit with zone controls
- TV points to all bedrooms
- Satin chrome electric sockets above worktops in kitchen
- Satin chrome USB/mobile charger socket to kitchen
- Shaver point to en-suite
- Sky Digital wiring to living room & bedrooms (Sky subscription & equipment required)
- Electrical points as detailed drawings
- Low energy lighting to all rooms
- RCD protection to all sockets
- Smoke, heat & carbon monoxide detectors
- Window locks and insurance locks to external doors
- Outside light to front and rear of house
- Intruder alarm to SSAIB insurance standard
- Insulated GRP external doors & insulated automatic garage door
- Cold water tap to garage or external position (as plan)
- Landscaping to front garden and turfed or gravelled rear garden (as plan)
- Natural limestone facing to selected plots and walls (as plan)
- Block pavers to drives & parking areas (as plan)
- Treated boarded fencing (as plan)
- NHBC 10 Year Buildmark Warranty

2017.03a

All houses are freehold and all apartments are leasehold. The lease is 999 years from 2017. Management charges apply to all properties for maintenance of some paved areas, surface water drainage and landscaped areas. Details available from the site Sales Advisor.

Our policy of continuous improvement and assessment of new products may lead to certain details changing. Please check the current specification with our representative as this leaflet does not constitute a part of any contract nor does it constitute an offer. Russell Armer Ltd reserve the right to make alterations to the specification of the properties at anytime during the course of construction without prior notice.



SPECIFICATION



TENTERFIELD
KENDAL

PLOTS 9 - 11

- Item included as standard to all plots unless listed
- Optional item available at extra cost (subject to stage of construction of the property)

● Hacker kitchens by Webbs of Kendal with soft close drawers & doors	● Sectional insulated garage door
● Choice of Hacker worktop and upstand to kitchen	● Natural slate roofs
● AEG 'A' rated multifunction stainless steel electric oven	● Thermostatic radiator valves
● AEG touch control ceramic electric hob	● 'A' rated system boiler (5 year warranty) with pressurised cylinder
● Stainless steel cooker hood	● Seven day heating control unit with zone controls
● Composite granite-style one and a half bowl sink	● TV points to all bedrooms
● Hansgrohe swivel spout sink mixer tap	● Satin chrome electric sockets above worktops in kitchen
● Zanussi A+ rated integrated tall fridge freezer (70/30)	● Satin chrome USB/mobile charger socket to kitchen
○ Zanussi A+ rated integrated dishwasher	● Shaver point to en-suite
● Zanussi integrated condenser washer/dryer	● Sky Digital wiring to living room & bedrooms <small>(Sky subscription & equipment required)</small>
● LED integral wall under unit lights	● Electrical points as detailed drawings
● Duravit bathroom pottery	● Low energy lighting to all rooms
● 105 vanity basin with storage to master en-suite	● RCD protection to all sockets
● Hansgrohe chrome taps & thermostatic shower pipe with shower head & hand shower to en-suite	● Smoke, heat & carbon monoxide detectors
● Hansgrohe thermostatic bath mixer with shower kit to bathroom	● Window locks and insurance locks to external doors
● Chrome heated towel rail to family bathroom	● Outside light to front and rear of house
● Chrome heated towel rail to en-suite	● Intruder alarm to SSAIB insurance standard
● Cloakroom/bathroom/en-suite half tiled to all walls	● Insulated timber composite main entrance door
○ Amtico flooring to bathroom and en-suite	● Cold water tap to garage or external position <small>(as plan)</small>
● LED inset spotlights to kitchen, bathroom & en-suite <small>(as plan)</small>	● Landscaped gardens
● Moulded skirting and architraves	● Natural limestone facing <small>(as plan)</small>
● Oak veneer internal doors with contemporary chrome door handles	● Block pavers to parking areas <small>(as plan)</small>
● Double glazed painted hardwood windows	● Treated boarded fencing <small>(as plan)</small>
● Energy efficient thermally lined construction to building regulations	● NHBC 10 Year Buildmark Warranty

2017.04a

All houses are freehold and all apartments are leasehold. The lease is 999 years from 2017. Management charges apply to all properties for maintenance of some paved areas, surface water drainage and landscaped areas. Details available from the site Sales Advisor.

Our policy of continuous improvement and assessment of new products may lead to certain details changing. Please check the current specification with our representative as this leaflet does not constitute a part of any contract nor does it constitute an offer. Russell Armer Ltd reserve the right to make alterations to the specification of the properties at anytime during the course of construction without prior notice.



SPECIFICATION



TENTERFIELD
KENDAL

PLOTS 12, 14, 15, 17 & 19

- Item included as standard to all plots unless listed
- Optional item available at extra cost (subject to stage of construction of the property)

- Hacker kitchens by Webbs of Kendal with soft close drawers & doors
- Hacker worktop and upstand to kitchen
- AEG 'A' rated multifunction stainless steel electric oven
- AEG touch control ceramic electric hob
- Stainless steel cooker hood
- Composite granite-style one and a half bowl sink
- Hansgrohe swivel spout sink mixer tap
- Zanussi A+ rated integrated tall fridge freezer (70/30)
- Zanussi A+ rated integrated dishwasher
- Zanussi integrated washer/dryer
- LED integral wall under unit lights
- Duravit bathroom pottery
- os vanity basin with storage to master en-suite
- Hansgrohe chrome taps & thermostatic shower pipe with shower head & hand shower to en-suite
- Hansgrohe thermostatic bath mixer with hair wash shower head to bath or with shower rail to bathroom where no en-suite
- Chrome electric heated towel rail to en-suite & bathroom
- Bathroom/en-suite half tiled to all walls
- Amtico flooring to bathroom and en-suite
- LED inset spotlights to kitchen, bathroom & en-suite (as plan)
- Moulded skirting and architraves
- Oak veneer internal doors with contemporary chrome door handles
- Double glazed painted hardwood windows
- Energy efficient thermally lined construction to building regulations
- Natural slate roofs
- Santon electric hot water cylinder
- Nobo electric panel heaters with individual timer/heating controls
- Door entry phone to plots 15, 17 & 19
- Satin chrome electric sockets above worktops in kitchen
- Satin chrome USB/mobile charger socket to kitchen
- TV points to all bedrooms
- Shaver point to en-suite or bathroom where no en-suite
- Sky Digital wiring to living room & bedrooms
(Sky subscription & equipment required)
- Electrical points as detailed drawings
- Low energy lighting to all rooms
- RCD protection to all sockets
- Smoke & heat detectors
- Window locks and insurance locks to external doors
- Landscaped gardens to plots 12 & 14
- Block pavers to parking areas (as plan)
- Treated boarded fencing (as plan)
- NHBC 10 Year Buildmark Warranty

2017.03a

All houses are freehold and all apartments are leasehold. The lease is 999 years from 2017. Management charges apply to all properties for maintenance of some paved areas, surface water drainage and landscaped areas. Details available from the site Sales Advisor.

Our policy of continuous improvement and assessment of new products may lead to certain details changing. Please check the current specification with our representative as this leaflet does not constitute a part of any contract nor does it constitute an offer. Russell Armer Ltd reserve the right to make alterations to the specification of the properties at anytime during the course of construction without prior notice.



SPECIFICATION



TENTERFIELD
KENDAL

AFFORDABLE HOMES PLOTS 16 & 18

- Item included as standard to all plots unless listed
- Optional item available at extra cost (subject to stage of construction of the property)

- Hacker kitchens by Webbs of Kendal with soft close drawers & doors
- Hacker worktop and upstand to kitchen
- Single bowl stainless steel sink
- Vado sink tap
- White bathroom pottery
- Vado chrome taps
- Vado chrome bath tap with hair wash shower head
- Heated towel rail to family bathroom
- Full tile to bath end wall, half tiled to bath & splashback to basin
- Amtico flooring to bathroom and en-suite
- Moulded skirting and architraves
- Oak veneer internal doors with contemporary chrome door handles
- Double glazed painted hardwood windows
- Thermal lined construction to building regulations
- Natural slate roofs

- Santon electric hot water cylinder
- Nobo electric panel heaters with individual timer/heating controls
- Door entry phone
- TV points to all bedrooms
- Satin chrome electric sockets above worktops in kitchen
- Satin chrome USB/mobile charger socket to kitchen
- Sky Digital wiring to living room & bedrooms
(Sky subscription & equipment required)
- Electrical points as detailed drawings
- Low energy lighting to all rooms
- RCD protection to all sockets
- Smoke & heat detectors
- Window locks and insurance locks to external doors
- Block pavers to parking areas (as plan)
- NHBC 10 Year Buildmark Warranty

2017.03a

All houses are freehold and all apartments are leasehold. The lease is 999 years from 2017. Management charges apply to all properties for maintenance of some paved areas, surface water drainage and landscaped areas. Details available from the site Sales Advisor.

Our policy of continuous improvement and assessment of new products may lead to certain details changing. Please check the current specification with our representative as this leaflet does not constitute a part of any contract nor does it constitute an offer. Russell Armer Ltd reserve the right to make alterations to the specification of the properties at anytime during the course of construction without prior notice.



Russell Armer
Homes

01539 724282
www.russell-armer.co.uk